

13 Oct 1956

85° E of MN
South entrance
Point south Pot

365 yds
5 1/2 W of MN
3 1/2 W of MN
373 yds from old
pile rocks to south
pot

83 1/2° E of MN
North entrance
100 yds
Right side of marker
Point north pot

at this marker
19 1/2 miles to each
center point (B) to (C)
5.0 above
center (A)

west of main ridge
640 yds at 10.5° N
south of (A)

84 1/2° E of MN
Intra lake 368 yds from (B)
5 1/2 W of MN
3 1/2 W of MN

685 yds from (D) to (E)
3.0 W of MN
Back along 558 yds from (B)

at (A) on
east of main ridge
840 yds at 10.5° N
Small tree just 20
yds of ridge 1200
yds 11.5° N

84 1/2° E of MN

660 yds
from (C)
11.0° N

11.5° N
from (C)

455 yds
11.5° N

Ⓐ to Ⓑ 20/10/56 $\frac{870 \text{ yds}}{855 \text{ yds}}$

correction
 $\frac{870}{855} - 40$

Probable range
 $\frac{815 \text{ yds}}{455 \text{ yds}}$

Ⓓ to Ⓐ 13/10/55
 $\frac{455 \text{ yds}}{395 \text{ yds}}$

correction
 $\frac{455}{395} - 60$

Total span Ⓐ to Ⓓ 1210 yds. = 3630 ft.

Ⓐ to Ⓑ 13/10/56 $\frac{365 \text{ yds}}{313 \text{ yds}}$

correction
 $\frac{365}{313} - 52$

Probable range = 942 ft. = 287 meters

520 Rc = 576 meters

We use spacing present autumn Ⓐ to Ⓑ $\frac{287}{576} = 0.498$ wavelength.

Say 0,500 wavelength for calculation

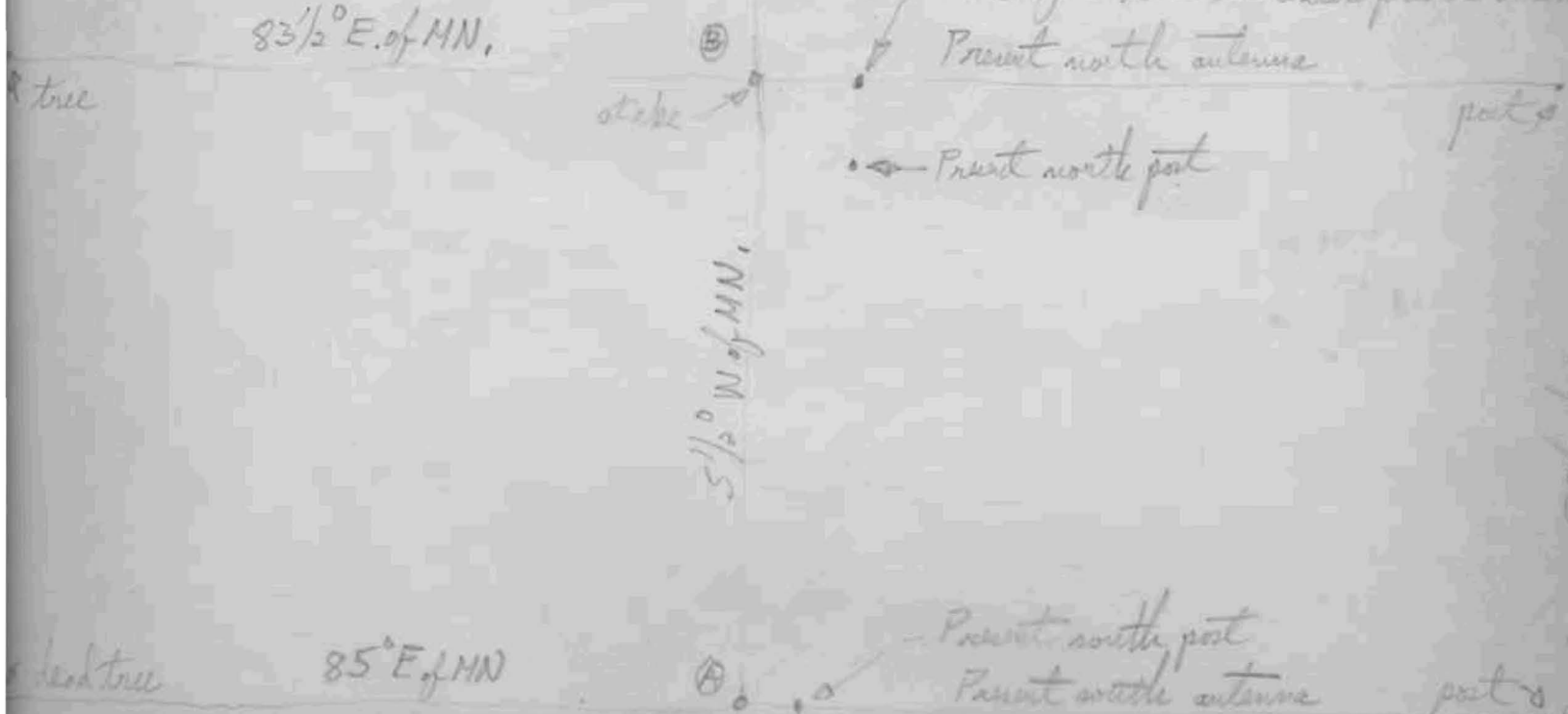
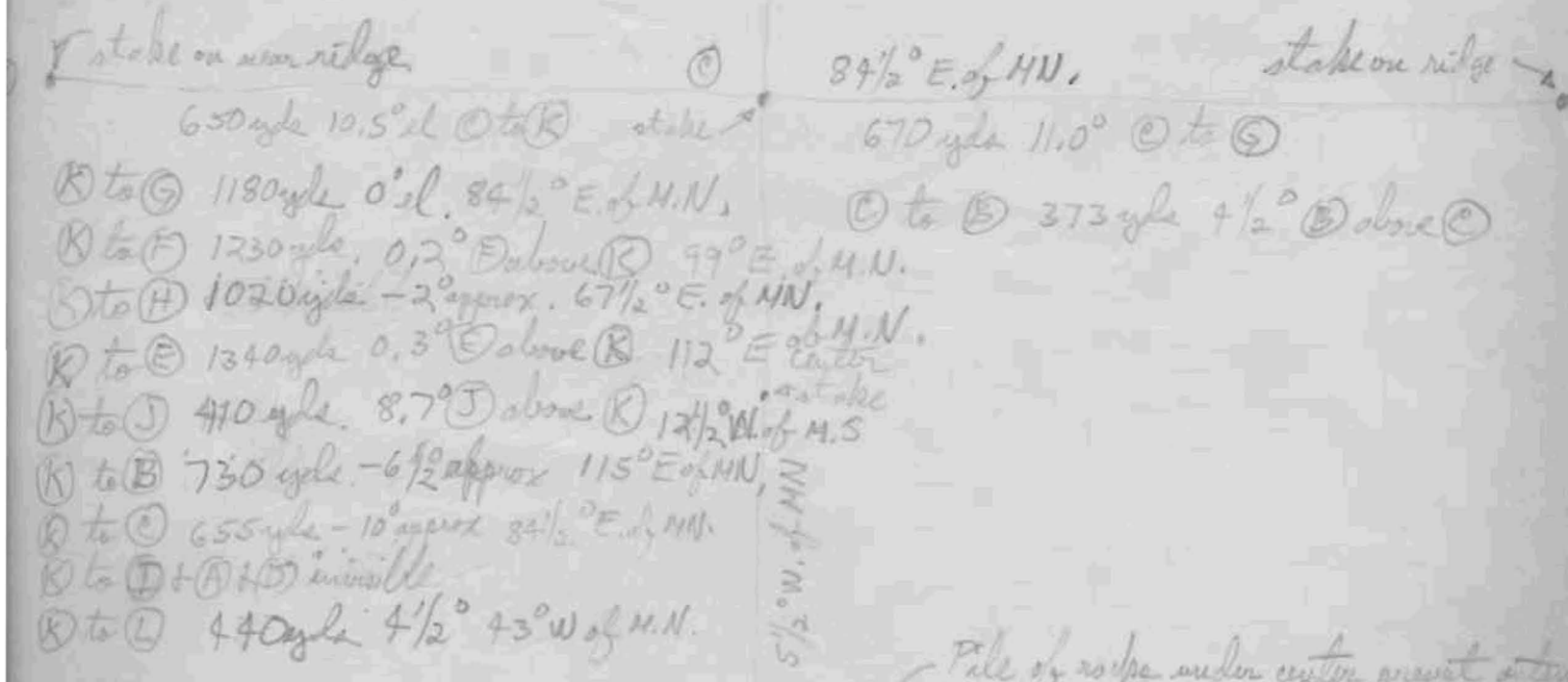
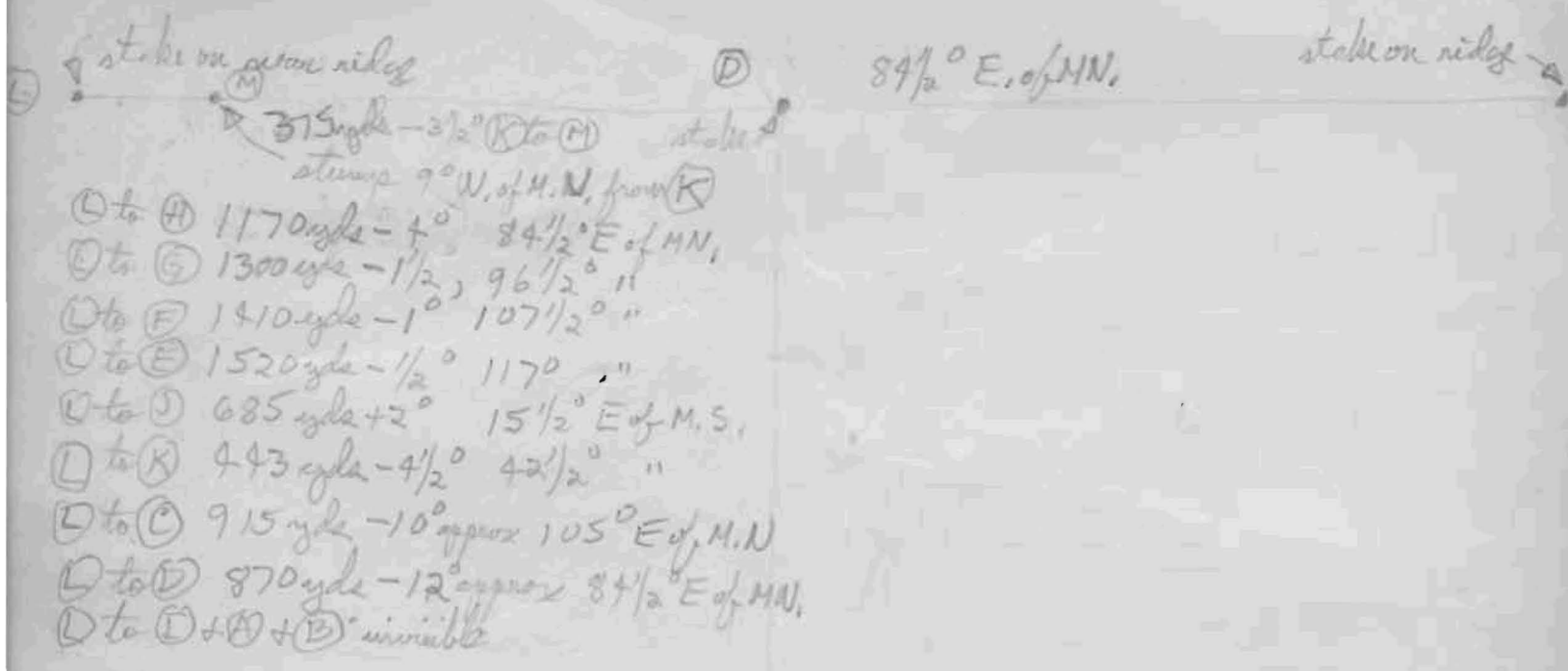

31 Dec 56. Put up fourth and most northerly antenna. Wire lengths are as follows:
 west 100, 200, 200, 400, 400, 1100, 150, 100 east. About 15 ft coiled around west post and
 75 ft coiled around east post. True span is 3660 ft. (H) to (D) on 2/1/57 took 100 ft from east end
 and replaced it by a 25 ft piece after pulling up.

By 20/10/56 (4/10/57) to (C) 573 yds - 520 ft = 9.63 ft.

9.63 ft = 294 meters = 2519 mm = 101.1 in

By 21/10/56 (29/10/57) to (C) 623 yds = 1879 ft.

Fourth down but about 60 ft. south of (C). True distance from 3rd to 4th antenna is

antenna (A) 1597 - 913 = 684 ft.

876 ft = 268 meters = 445 mm = 17.5 in

Total length of wire of antenna is

- (A) to (C) = 1498
 - (B) to (C) = 1509
 - (C) to (D) = 1466
-
- 1472

This is a tangle about 1.5λ. The pole is vertical on
 north part of east side; it should be placed about 100 ft
 to north of present top post. This will straighten out
 present north antenna and make it a full 1.5λ long.

① A to B 363 yds 3.1°

② to B 373 yds. 4.0°

① to insulator at center of dome
378 yds 16.5°

② to insulator at center of dome
387 yds. 17.4°

By measure the antenna down lead was brought directly down to over pile of rocks.

The length from 5 ft above ground to end of lead is 53 ft 6". The tension is about down as at post. The red pin is about

5 ft below pile of rocks. There post for tower box should be about 48 ft

north of yellow indicating new position of down lead.

25-21-8

-51 = 312 yds x 3.1°
3 x .054 = 51 ft

373 - 52 = 321 yds x 4.0°
321 x 3 x .070 = 68 ft

① above ②

① above ②

#1 antenna

Took down

W 200, 400, 1100, 1100, 400, 400, 100 E 31/8/57

#2 antenna

W 200, 400, 400, 1100, 1100, 400, 200, 125, 35 E

#3 antenna

W 35, 200, 400, 1100, 1100, 400, 200, 100 E

#4 antenna

W 35, 100, 400, 400, 400, 1100, 1100, 200 E

Extra lengths

25, 100, 150, 200, 200, 400, 400

3 aug 57 changed #4 antenna to

W 35, 100, 400, 400, 200, 200, 1100, 1100, 400, 400, 200, E

Took down 31/8/57

Took down on 27/7/57

Tom Cooper, head of HEC at
New Norfolk, Tel. in N.N. 55

His boss is Vic Shore at room 212
HEC building in Hobart

SATURDAYS MERCURY (Public Notice Column)

THE HYDRO-ELECTRIC COMMISSION

TASMANIA

NOTICE TO CONSUMERS

INTERRUPTION TO POWER SUPPLY

Consumers in the undermentioned areas are notified that the supply of electricity will be interrupted from 1.30 p.m. and 4.30 p.m., Sunday 19 .

Bothwell or Tarcho or OATLANDS.

(W.R. Spinner)
Secretary

MERCURY HOBART: INSERTION: SATURDAY,

EXAMINER LAUNCESTON: INSERTION: SATURDAY,

A.B.C. HOBART: ANNOUNCEMENT: SATURDAY,

ALLOCATION:

GR/MGB
11/10/1955.

Pole at east end #4 antenna

29/6/57

Bearings from pole position three line across valley 96° ~~West~~ ^{of} Magnetic north.

Length of Stays

NW anchor	150 ft	+ 6 ft	down	171 ft	Top
NE "	"	+ 10 "	"	172 ft	"
SE "	"	+ 5 "	up	165 ft	"
SW "	"	+ 4 "	down	170 ft	"

Center stays all about 155 ft long

Uncorrected range to back anchor 320 yards.

Distance to back anchor = 310 ft = \leftarrow $\frac{-47}{+273}$ yds

From #4 antenna pole position to east end #3 post
420 yds uncorrected at elevation 6.2°

- 56 correction

364 yds corrected = 1092 ft

, $\sin 6.2^\circ = .108$

$1092 \times .108 = 118$ ft bottom pole at east end #4 is below anchor at east end #3

- 75 ft height of pole

43 ft Top of pole below anchor #3.

- 25 ft approx sag in #3 from anchor to end of antenna

18 ft = #4 antenna below #3 antenna.

29/6/57

Pole at west end #3 antenna

Length of stay

NW anchor	150ft	3 ft down	169ft Top
NE anchor	"	15 ft down	175ft "
SE "	"	6 ft down	171ft "
SW "	"	15 ft up	162ft "

center stays all about 155 ft long.

Unconverted range to back anchor 290 yds.
conversion $\frac{-44}{290}$

Distance to back anchor = 738 ft = 246 yds

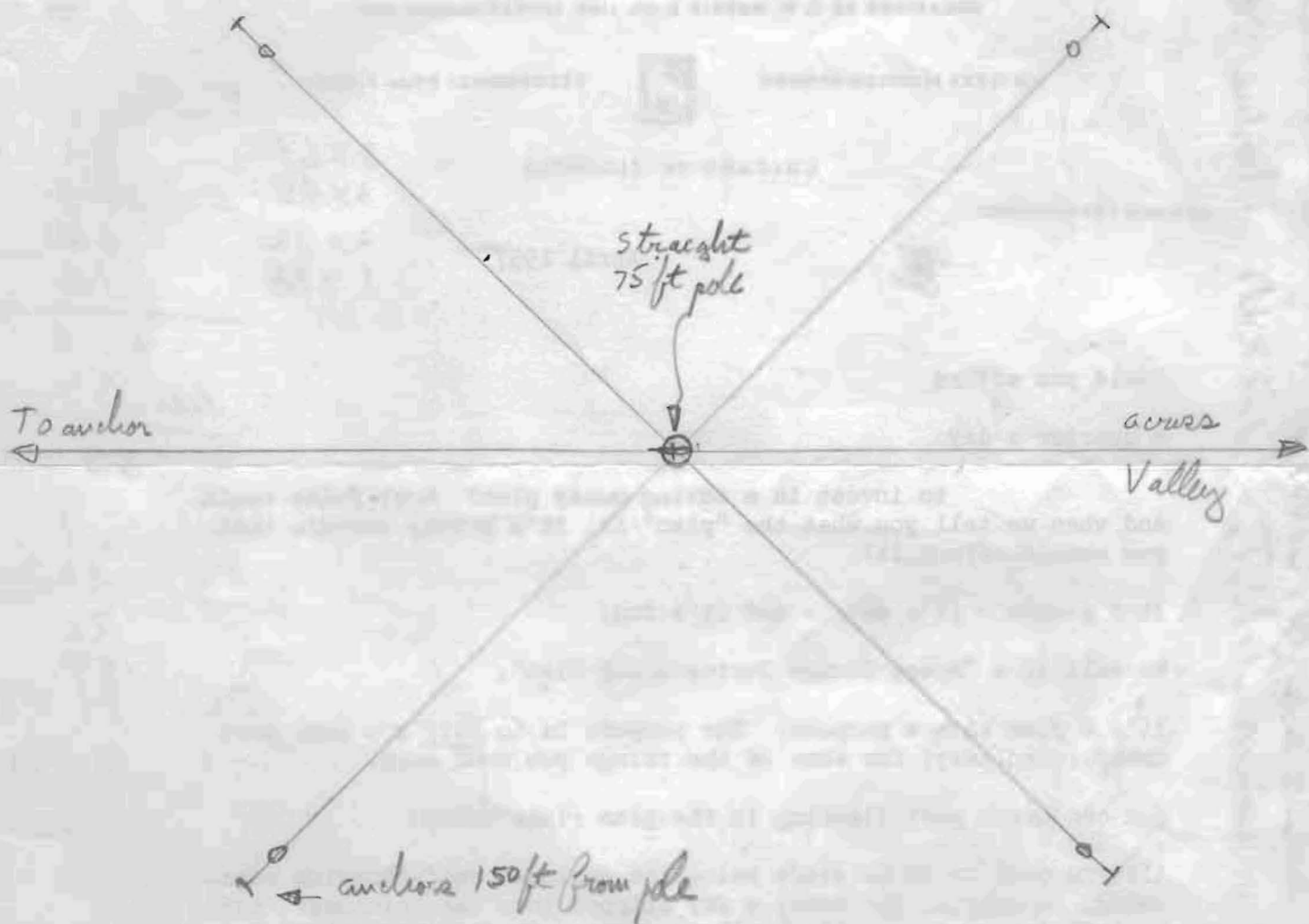

Wheel + insulators supplied to contractor by G. Reber
 Contractor must carry accident insurance and sign paper
 freeing land owner + purchaser from all damage claims.

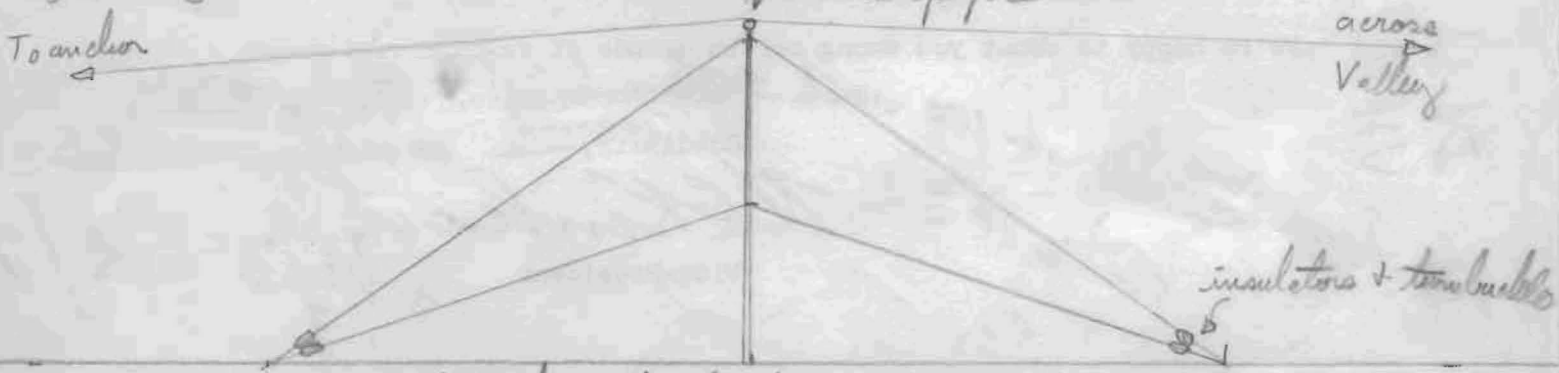

Stays fastened to pole by through bolts
 Climbing irons every 1 1/2 ft on opposite sides of pole
 Top of pole flat + square for wheel assembly.

Grote Reber
 20/6/57



1000 1100 1200 1300 1400 1500 1600

Range Readings

29/4/56

all for true range

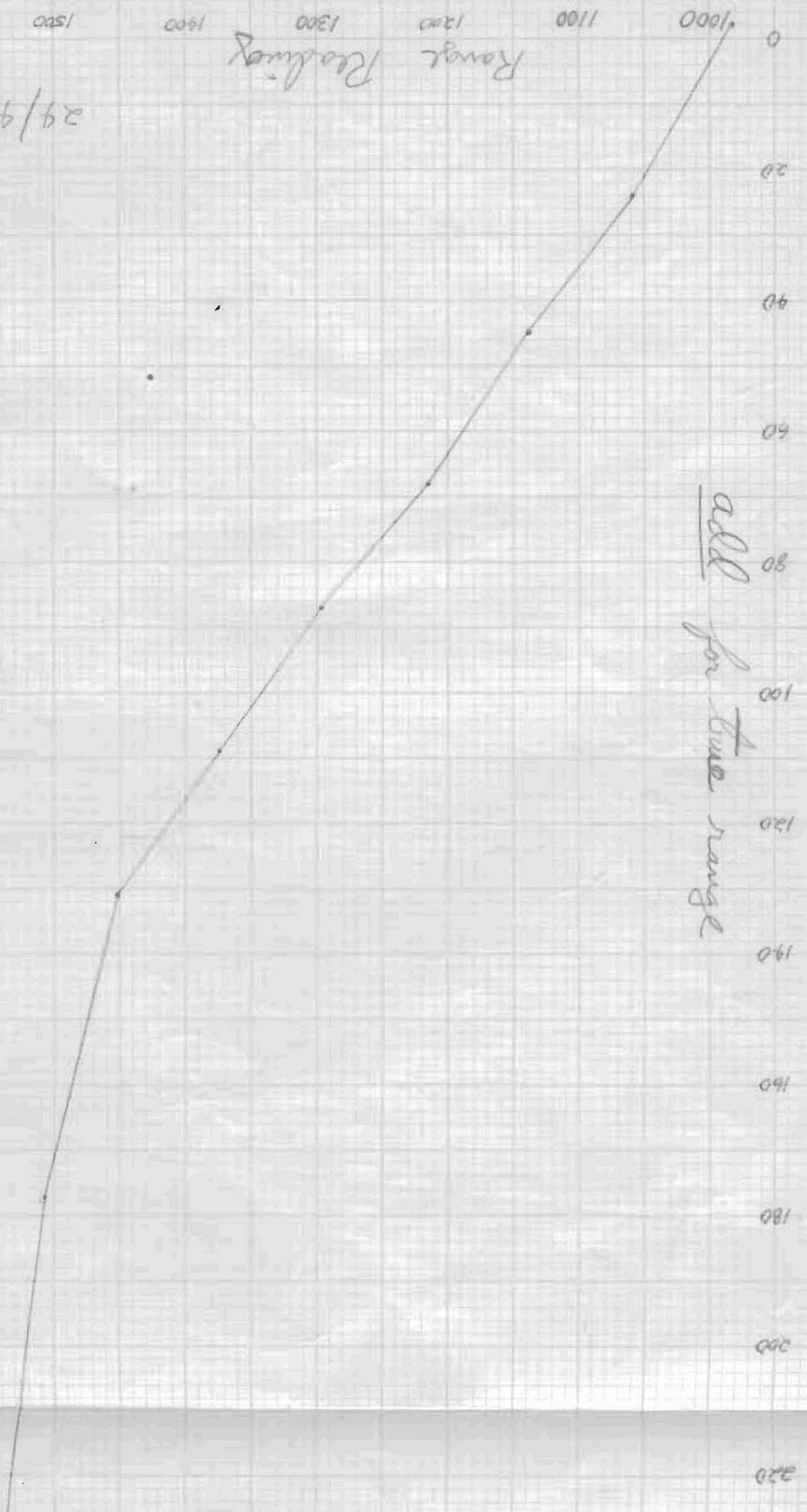

Subtract for True Range

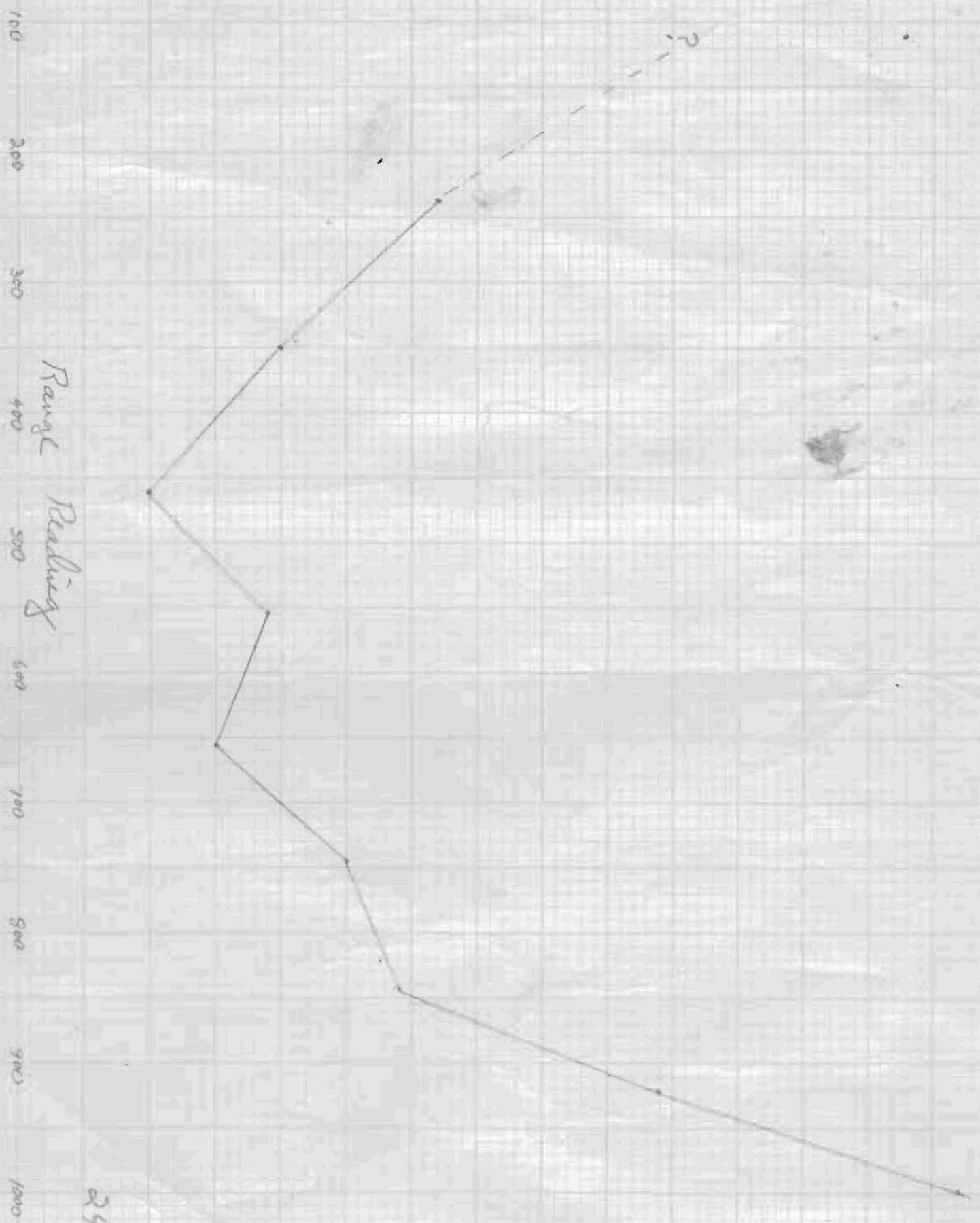

24/4/56